

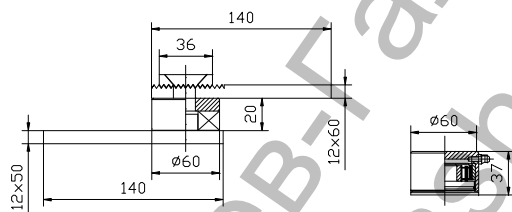

## Панта Estebro® за заваряване за летящи врати долна с рамо, с лагер ф 60 мм, 3372



Cod	Dimens.			Peso máx kg
337	60 mm Juego Jogo-Set-Jeu	1	2,85	600
3371	60 mm Superior Upper-Supérieur	2	4,20	600
3372	60 mm Inferior Lower Inférieur	2	1,45	2000

**Family:** Swing gate

**Material:** 11SMn30 steel, F1 steel

**Finish:** Zinc-plated

**Maximum weight supported\*:** See table

**Description:** It is composed of two parts: Upper and Lower. The upper part is installed by welding the square to the upper part of the door and the plate to the frame, otherwise by fitting it into the concrete of the wall. The lower part is welded to the piece installed on the floor and to the lower part of the door, allowing its opening and closing.

\*In perfect conditions of installation, usage and maintenance.

Продукт: [Панта Estebro® за заваряване за летящи врати долна с рамо, с лагер ф 60 мм, 3372](#)

Категория: [Панти за заваряване](#)

Бранд: [Estebro®](#)

Категория бранд: [Панта Estebro®](#)